

MENSOLINE

ART. 672 MENSOLINE DOPPIE FERRO ZINCATO

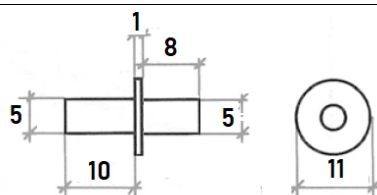

ART. 50623 MENSOLINE DOPPIE FERRO ZINCATO

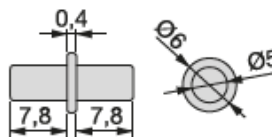

ART. 514 MENSOLINE NYLON DOPPIE

COLORI BIANCO MARRONE

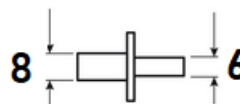

ART. 16181 MENSOLINE FERRO NICHELATO

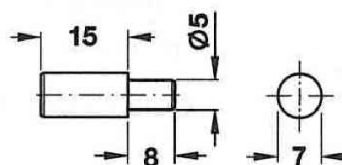

**ART. 71 MENSOLINE FERRO NICHELATO
A PALETTA PERNO MM 5**

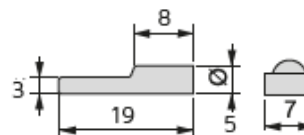

**MENSOLINE IN FERRO CON O-RING IN GOMMA
PERNO MM 5**

ART. 80395 NICHELATE

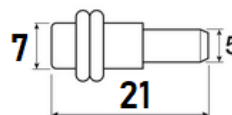

**MENSOLINE OTTONE CON O.RING IN GOMMA
FILETTO M5**

ART. 625 NICHELATE

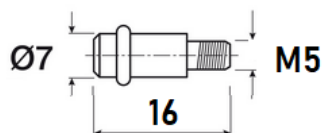

MENSOLINE

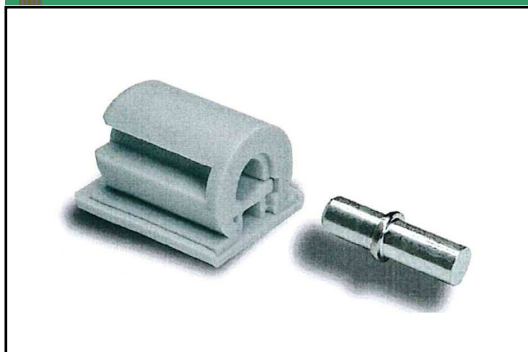

ART. 951 MENSOLINE AD INCASSO CON SISTEMA DI ANTI-RIBALTAMENTO

COLORI	BIANCO-GRIGIO- NERO
--------	---------------------

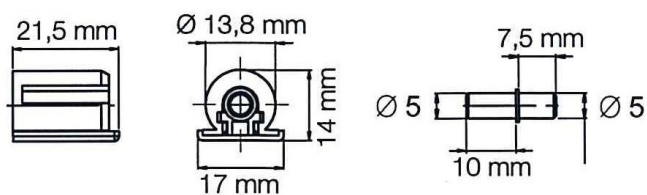

ART. 28242 MENSOLINE AD INCASSO CON PERNO A MOLLA

COLORE	GRIGIO
--------	--------

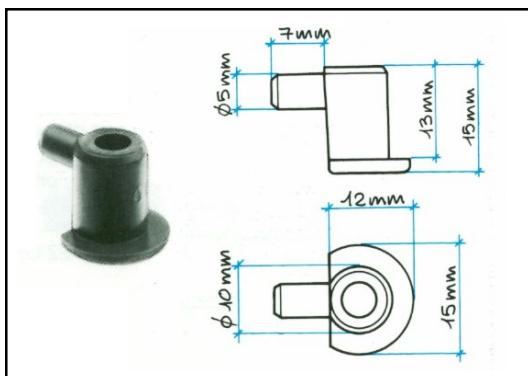
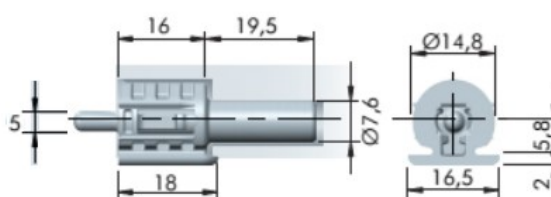

ART. 940 MENSOLINE NYLON DA INCASSO PERNO DA MM 5

COLORE	BIANCO MARRONE
--------	----------------



ART. 53 MENSOLINE IN OTTONE CON GHIERA IN PLASTICA E FORO CENTRALE

COLORI	BIANCO—MARRONE
--------	----------------

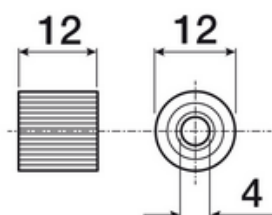

MENSOLINE NYLON CON VENTOSA BIANCO-MARRONE-NERO-TRASPARENTE

ART. 617	PERNO LISCIO MM 5
-----------------	-------------------

ART. 618	PERNO FILETTATO M5
-----------------	--------------------

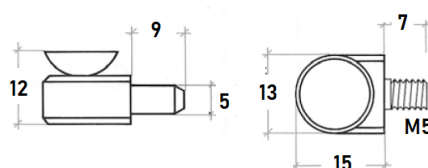

MENSOLINE

MENSOLINE IN ZAMA CON VENTOSA

ART. 80450

NICHELATE

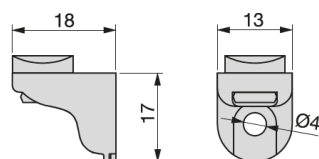

MENSOLINE IN ZAMA PERNO MM 5 E FORO MM 6

ART. 942

NICHELATE

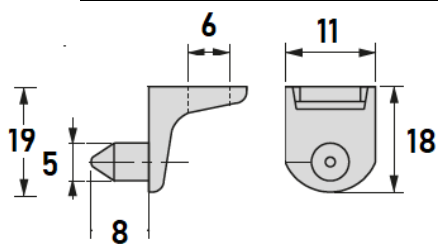

MENSOLINE IN ZAMA CON PERNO

ART. 40304

NICHELATE

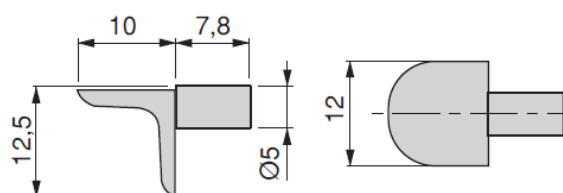

MENSOLINE IN ZAMA CON PERNI MM 5

ART. 40103

NICHELATE

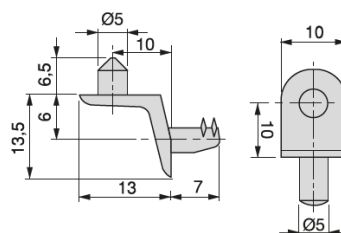

MENSOLINE IN NYLON CON PERNI MM 5

ART. 90154

NERO

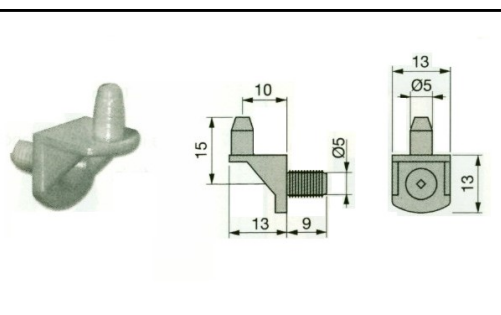

MENSOLINE

MENSOLINE IN OTTONE TORNITO

ART. 75

NATURALE- BRONZATO

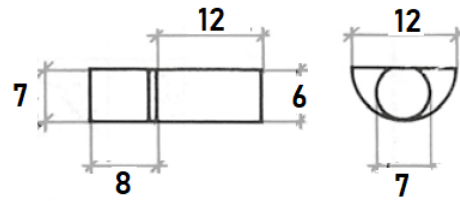

MENSOLINE IN OTTONE TORNITO PERNO FILETTATO M5

ART. 620

NATURALE- BRONZATE-NICHELATE

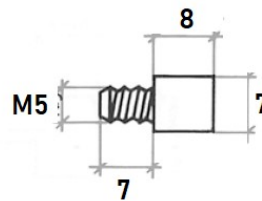

BUSSOLE OTTONE TORNITO FILETTO M5

ART. 621

NATURALE- BRONZATE-NICHELATE

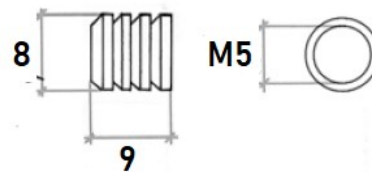

MENSOLINE PLASTICA CON FORI

ART. 109

BIANCO-MARRONE

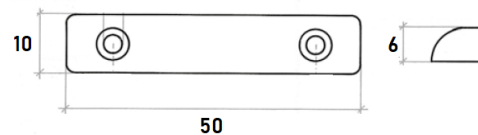

MENSOLINE PLASTICA CON CHIODI

ART. 108

BIANCO-MARRONE



REGGIMENSOLE



REGGIMENSOLE IN OTTONE A MORSETTO PER CRISTALLI
MAX MM 10—D.20X25

ART. 556/01	OTTONE LUCIDO
ART. 556/03	NICHEL SATINATO
ART. 556/07	CROMO LUCIDO



REGGIMENSOLE IN OTTONE A MORSETTO PER CRISTALLI
MAX MM 10—MM 50X25

ART. 553/01	OTTONE LUCIDO
ART. 553/03	NICHEL SATINATO
ART. 553/07	CROMO LUCIDO



REGGIMENSOLE IN ZAMA

ART. RM04	CROMATO-NICKEL SATINATO
-----------	-------------------------

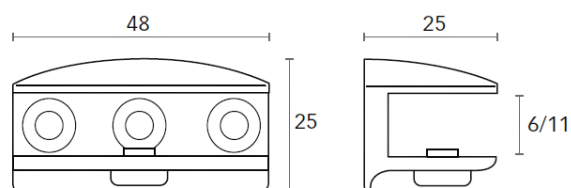

REGGIMENSOLE PIO PIO

ART. 547 (EX309B)	CROMATO-NICKEL SATINATO VERNICIATO ARGENTO
-------------------	---

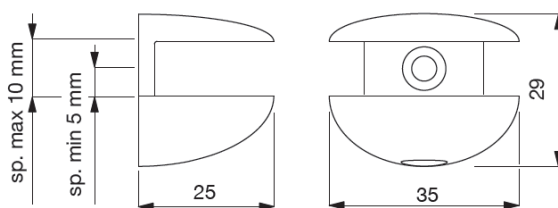

REGGIMENSOLE QUA QUA

ART. 546 (EX309A)	CROMATO-NICKEL SATINATO VERNICIATO ARGENTO
-------------------	---

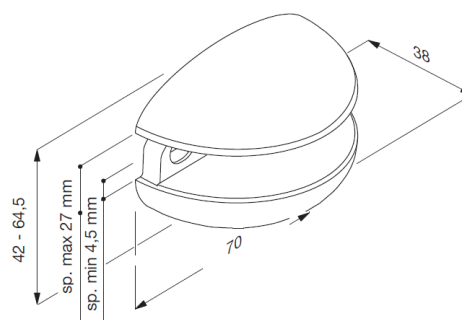

REGGIMENSOLE

ART. 510 REGGIMENSOLE IN ZAMA S=MM 0-30

FINITURE CROMATO-VERNICIATO ARGENTO

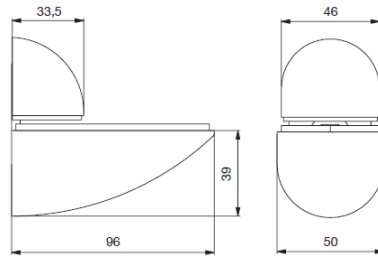

ART. RM10 REGGIMENSOLE IN ZAMA

FINITURE CROMATO-ECONICH-NICH.SATINATO

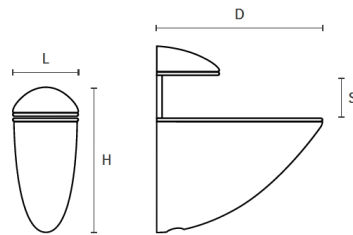

ART	L	H	D	S
RM10A	40	88	106	0/32
RM10B	31	68	75	0/18
RM10C	29	56	55	0/14

ART. HALCON REGGIMENSOLE IN ZAMA

FINITURE VERN. ARGENTO-VERN.NICH.SATINATO

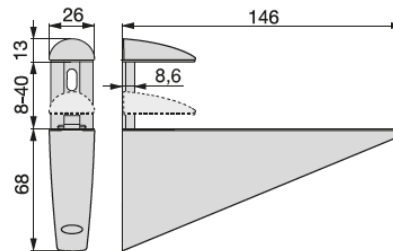

ART. RM06 REGGIMENSOLE IN ZAMA

FINITURE NICHEL SATINATO

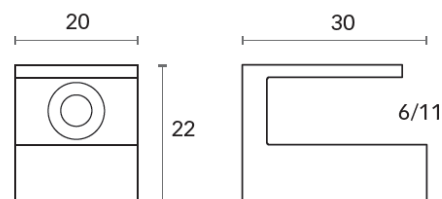

ART. RM01 REGGIMENSOLE IN ZAMA

FINITURE NICHEL SATINATO

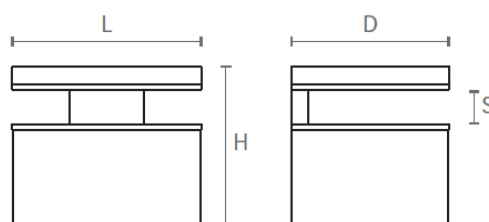

ART	L	H	D	S
RM01A	65	43	40	8/20
RM01B	30	25	25	6/8

REGGIMENSOLE

ART. RM02B REGGIMENSOLE IN ZAMA

FINITURE CROMO-ECONICHEL

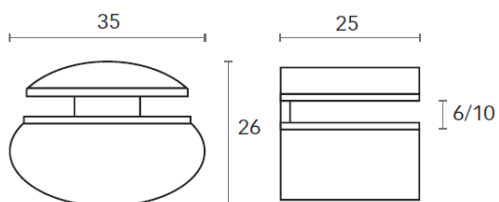

ART. RM08 REGGIMENSOLE IN ZAMA

FINITURE CROMATO-NICHEL SATINATO

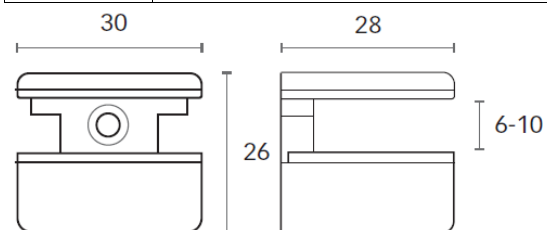

ART. RM65 REGGIMENSOLE IN ZAMA

FINITURE CROMATO-NICHEL SATINATO

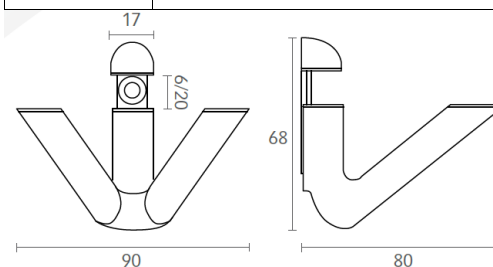

ART. RM40 REGGIMENSOLE IN ZAMA

FINITURE NICHEL SATINATO

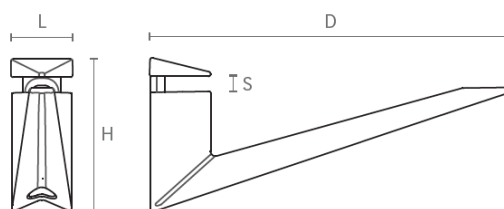

ART	L	H	D	S
RM40A	31	84	230	6/40
RM40B	26	63	150	6-26

ART. RM30 REGGIMENSOLE IN ZAMA

FINITURE CROMO LUCIDO-NICHEL SATINATO

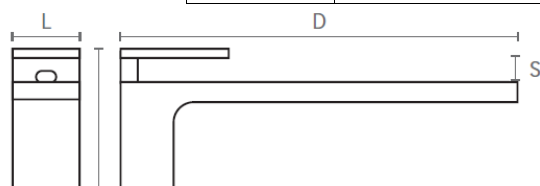

ART	L	H	D	S
RM30A	29	71	230	10/50
RM30B	25	54	147	8/35

REGGIMENSOLE

ART. RM30 REGGIMENSOLE IN ZAMA

FINITURE CROMO LUCIDO-NICHEL SATINATO

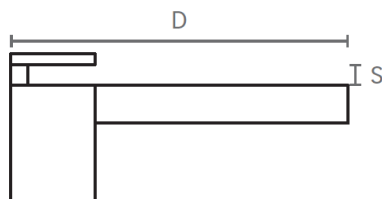
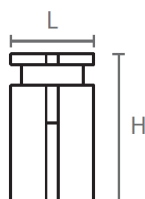

ART	L	H	D	S
RM35A	30	50	140	6/25
RM35B	20	35	80	5/18

ART. 513 REGGIMENSOLE IN ZAMA

FINITURA VERNICIATO ARGENTO

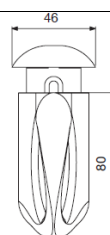
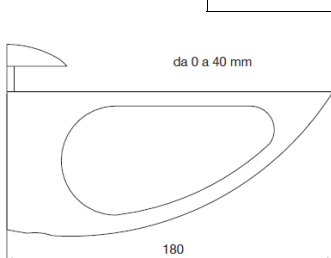

ART. 595 REGGIMENSOLE ALLUMINIO

FINITURE VERN.ARGENTO-VERN.NICHEL SATIN.

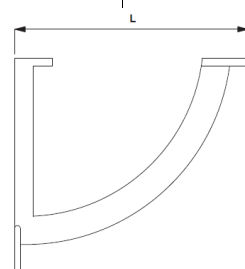
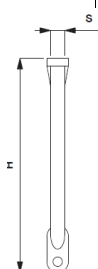

ART	L	H	S
595A	330	235	20
595B	190	175	16
595C	132	120	12

ART. RM20 REGGIMENSOLE ACCIAIO

FINITURE CROMO-NICHEL SATINATO

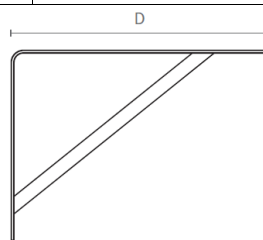

ART	L	H	D
RM20A	30	190	240
RM20B	25	140	190

ART. 300 REGGIMENSOLE ACCIAIO/COPERTURA ABS

COLORI BIANCO-NERO-MARRONE-FRASSINO

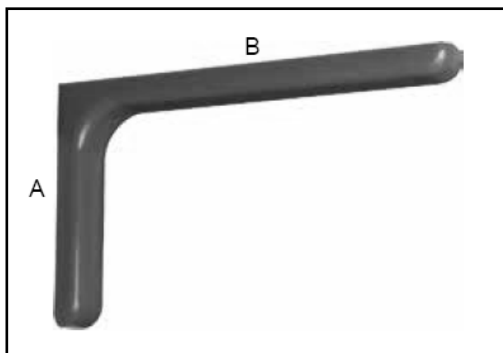

ART	A	B
300A	145	240
300B	115	185
300C	80	120

REGGIMENSOLE

REGGIMENSOLE IN FERRO ZINCATO

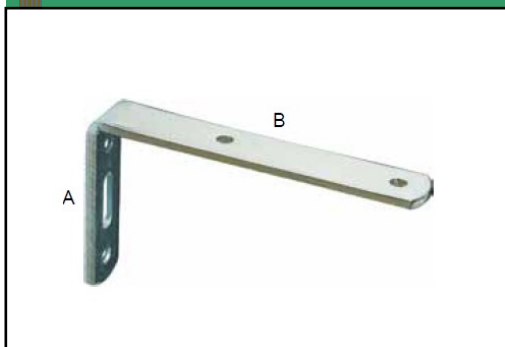

ART	A	B	SPESSORE
22	70	120	15X3
23	70	150	15X3
29	70	150	20X4
30	70	200	20X4

REGGIMENSOLE NERVATE ACCIAIO VERNICIATO BIANCO



ART	A	B
509672	100	125
509673	125	150
509674	150	200
509675	200	250
509676	250	300
509677	300	350

REGGIMENSOLE ACCIAIO CON RINFORZO

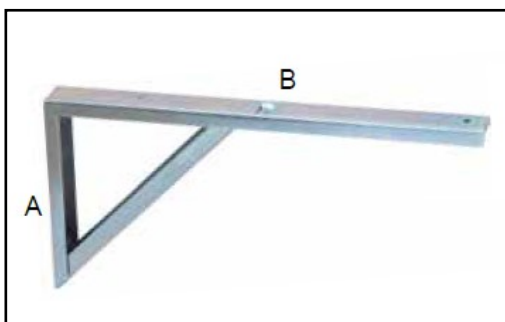

ZINCATO	BIANCO	NERO	A	B
ART 127	ART 343	ART 341	180	300
ART 128	ART 346	ART 344	180	400
ART 340	ART 348	ART 347	180	500

REGGIMENSOLE ACCIAIO PIEGHEVOLI BIANCHE

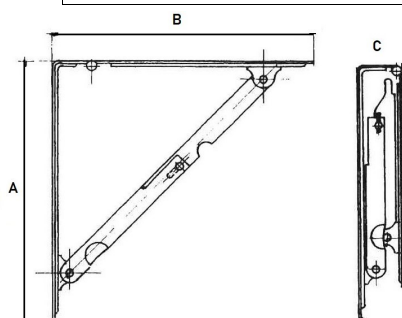

ART	A	B	C
656300	300	300	40
656400	400	400	40

REGGIMENSOLE ACCIAIO AUTOBLOCCANTI



ART	A	B	C
125001B		185	39
125002B		285	44

REGGIMENSOLE

REGGIMENSOLE IN FERRO BATTUTO

FINITURA NERO BUGNATO

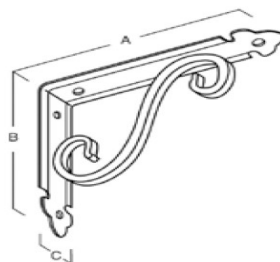

ART	A	B	C
2810X	155	125	30
2810Y	255	175	30
2810K	280	220	30

ART.810 REGGIMENSOLE INVISIBILI CON PIASTRA

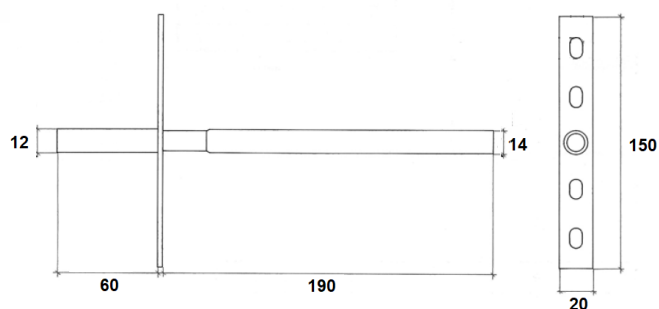

ART.69126 REGGIMENSOLE INVISIBILI REGOLABILI CON PIASTRA

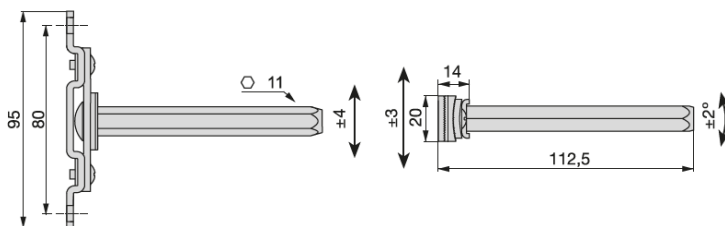

REGGIMENSOLE INVISIBILI / SEZIONE ESAGONALE

ARTICOLO	FORO RIPIANO	FORO PARETE	SPORGENZA
14933	MM 10	MM 12	MM 100
14934	MM 10	MM 12	MM 150
14930	MM 14	MM 14	MM 120
14931	MM 14	MM 14	MM 145
14932	MM 14	MM 14	MM 170

REGGIMENSOLE

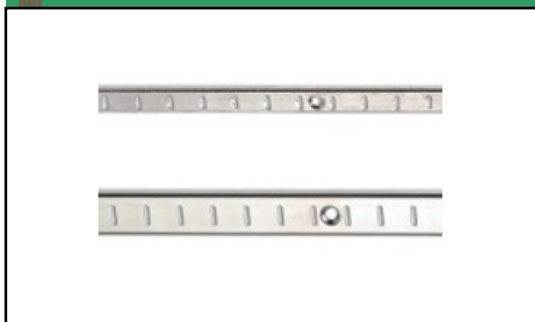

CREMAGLIERE IN FERRO NICHELATO E OTTONATO

ART 1250 LUNGHEZZA MM 1625 SEZIONE MM 12X4

ART 1255 LUNGHEZZA MM 1620 SEZIONE MM 20X4.5

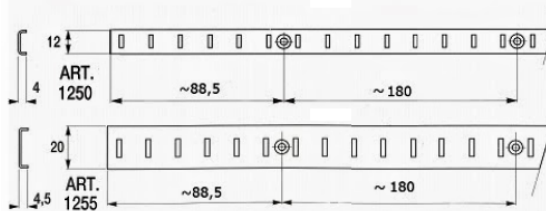

MENSOLINE PER CREMAGLIERE

ART 1251 MM 18X10

ART 1256 MM 28X15

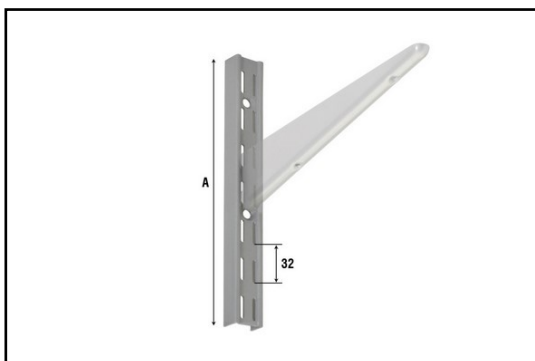
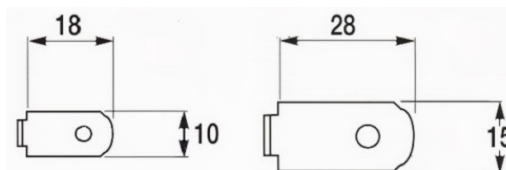

CREMAGLIERA IN ACCIAIO SEZ MM 24X16

ART 2750VB100 LUNGHEZZA MM 1000 VERN BIANCO

ART 2750VB160 LUNGHEZZA MM 1600 VERN BIANCO

ART 2750VB198 LUNGHEZZA MM 1980 VERN BIANCO

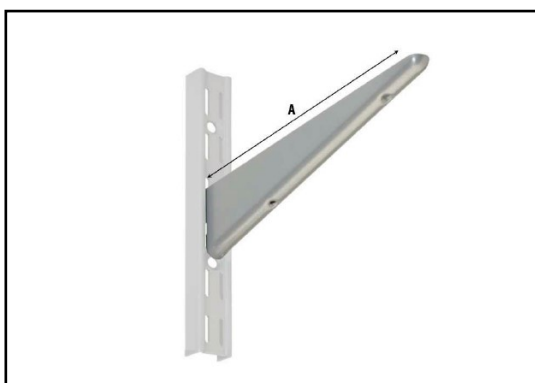

MENSOLE IN ACCIAIO

ART 2770VB20 MM 172X49

ART 2770VB25 MM 222X49

ART 2770VB30 MM 272X49

ART 2770VB35 MM 322X49

ART 2770VB40 MM 374X81

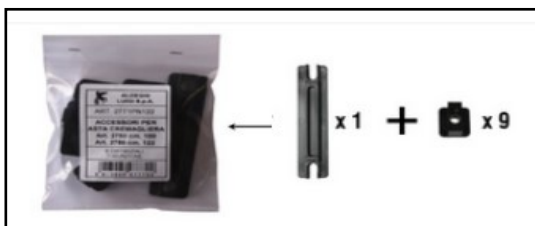

ART 2771PN198 SET GIUNZIONI E DISTANZIALI



ART 2774PNOO SET TAPPI

PROFILI A CREMAGLIERA PANNELLABILI

ARTICOLI SU ORDINAZIONE

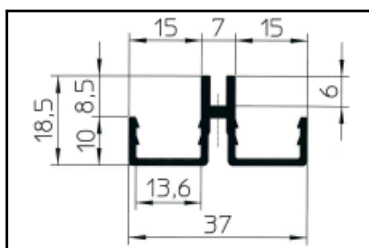

PROFILO A CREMAGLIERA CENTRALE FORATURA SINGOLA

C0010A2013A	LUNGHEZZA MM 2013 ARGENTO
C0010A2531A	LUNGHEZZA MM 2531 ARGENTO
C0010A3012A	LUNGHEZZA MM 3012 ARGENTO

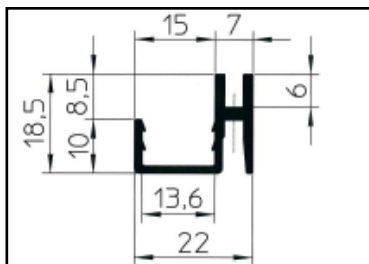

PROFILO A CREMAGLIERA LATERALE FORATURA SINGOLA

C0011A2013A	LUNGHEZZA MM 2013 ARGENTO
C0011A2531A	LUNGHEZZA MM 2531 ARGENTO
C0011A3012A	LUNGHEZZA MM 3012 ARGENTO

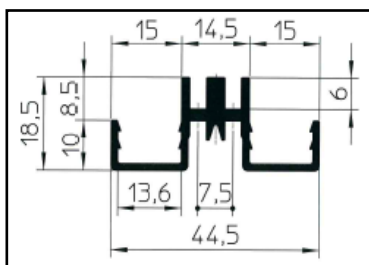

PROFILO A CREMAGLIERA CENTRALE FORATURA DOPPIA

C0012A2013A	LUNGHEZZA MM 2013 ARGENTO
C0012A2531A	LUNGHEZZA MM 2531 ARGENTO
C0012A3012A	LUNGHEZZA MM 3012 ARGENTO

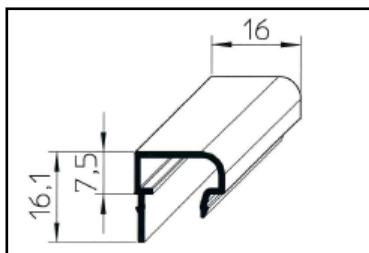

COPERTURA PROFILO STRETTO

E0010A2013A	LUNGHEZZA MM 2013 ARGENTO
E0010A2531A	LUNGHEZZA MM 2531 ARGENTO
E0010A3012A	LUNGHEZZA MM 3012 ARGENTO

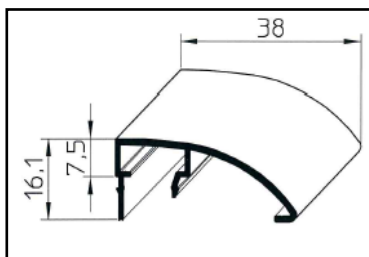

COPERTURA PROFILO LARGO

E0012A2013A	LUNGHEZZA MM 2013 ARGENTO
E0012A2531A	LUNGHEZZA MM 2531 ARGENTO
E0012A3012A	LUNGHEZZA MM 3012 ARGENTO

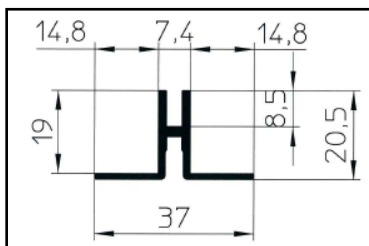

PROFILO A CREMAGLIERA CENTRALE FORATURA SINGOLA

C1900A3012A	LUNGHEZZA MM 3012 ARGENTO
--------------------	---------------------------



CLIP FISSAGGIO A VITE PER AGGANCI PANNELLI

60032P03200	
--------------------	--

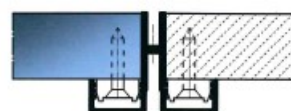

PROFILI A CREMAGLIERA PANNELLABILI

ARTICOLI SU ORDINAZIONE

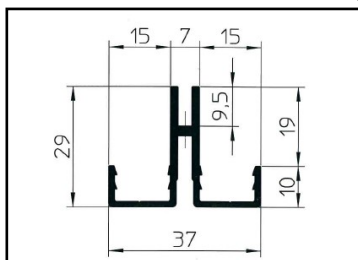

PROFILO A CREMAGLIERA CENTRALE FORATURA SINGOLA

C1910A2013A LUNGHEZZA MM 2013 ARGENTO

C1910A2531A LUNGHEZZA MM 2531 ARGENTO

C1910A3012A LUNGHEZZA MM 3012 ARGENTO

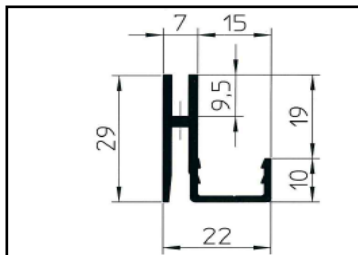

PROFILO A CREMAGLIERA LATERALE FORATURA SINGOLA

C1911A2013A LUNGHEZZA MM 2013 ARGENTO

C1911A2531A LUNGHEZZA MM 2531 ARGENTO

C1911A3012A LUNGHEZZA MM 3012 ARGENTO

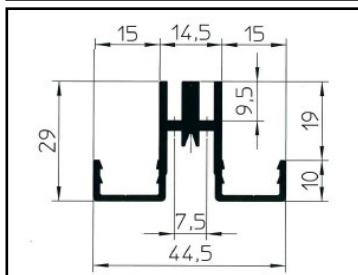

PROFILO A CREMAGLIERA CENTRALE FORATURA DOPPIA

C1912A2013A LUNGHEZZA MM 2013 ARGENTO

C1912A2531A LUNGHEZZA MM 2531 ARGENTO

C1912A3012A LUNGHEZZA MM 3012 ARGENTO

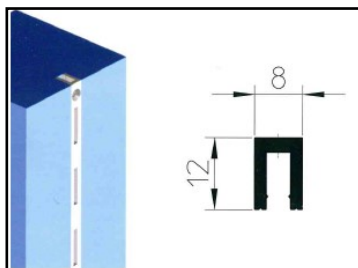

PROFILO LEGGERO A CREMAGLIERA

C0020A2013A LUNGHEZZA MM 2013 ARGENTO

C0020A2531A LUNGHEZZA MM 2531 ARGENTO

C0020A3012A LUNGHEZZA MM 3012 ARGENTO

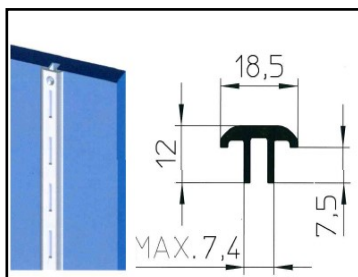

PROFILO LEGGERO A CREMAGLIERA CON COPERTURA LATERALE

C0022A2013A LUNGHEZZA MM 2013 ARGENTO

C0022A2531A LUNGHEZZA MM 2531 ARGENTO

C0022A3012A LUNGHEZZA MM 3012 ARGENTO

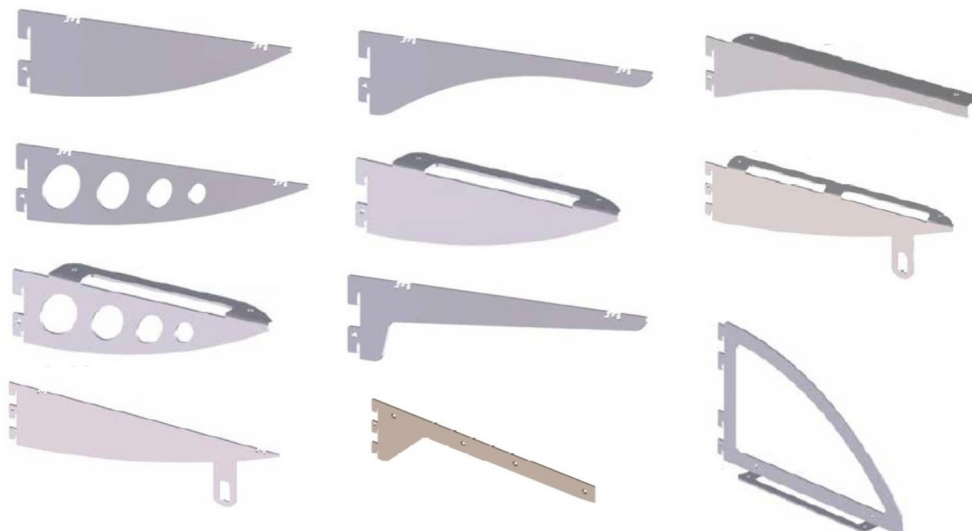

PROFILI A CREMAGLIERA PANNELLABILI

ARTICOLI SU ORDINAZIONE

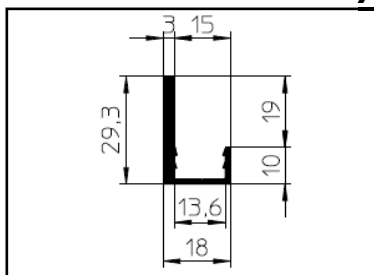

PROFILO CORNICE LATERALE NON ATTREZZABILE

BO011A3012A

LUNGHEZZA MM 3012 ARGENTO

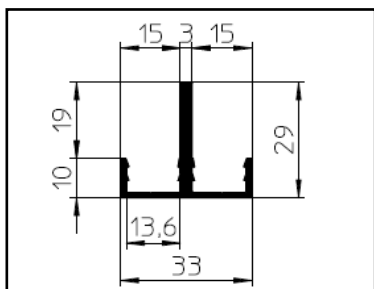

PROFILO CORNICE CENTRALE NON ATTREZZABILE

BO010A3012A

LUNGHEZZA MM 3012 ARGENTO

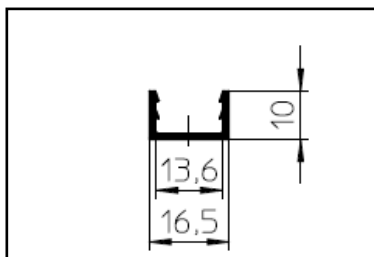

PROFILO LATERALE/TERMINALE NON ATTREZZABILE

B0001A3012Z

LUNGHEZZA MM 3012 ALLUMINIO GREZZO

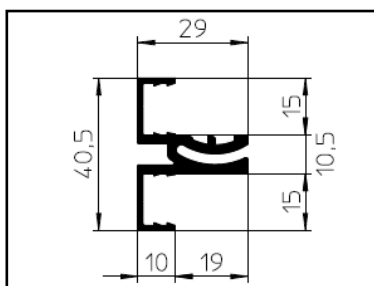
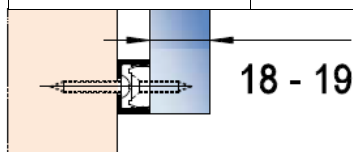

PROFILO ORIZZONTALE ATTREZZABILE

D0010A3012A

LUNGHEZZA MM 3012 ARGENTO

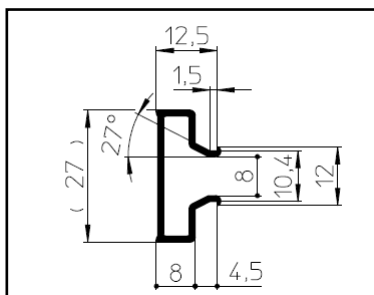
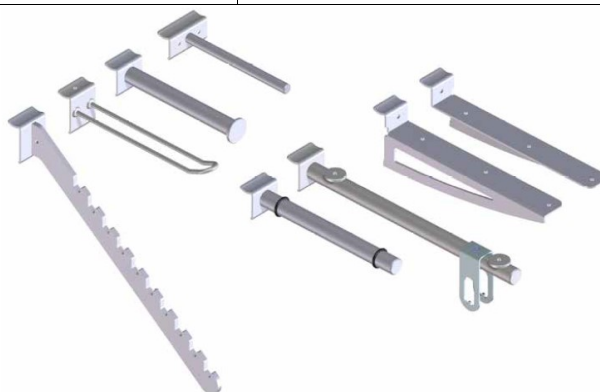

PROFILO PER PANNELLI DOGATI STANDARD

DSC01A3100Z

LUNGHEZZA MM 3100 ALLUMINIO GREZZO

REGGIMENSOLE



M1000 TUBI REGGIMENSOLE MM 1000

FINITURE	OTTONATO-CROMATO-NICHEL SATINATO-BIANCO-NERO OPACO
----------	--



KIT MORSETTI A CAVI PER MENSOLE SOSPESSE

MF12251	OTTONATO (CAVO INOX NATURALE)
MF12253	NICHEL LUCIDO
MF12255	NICHEL SATINATO

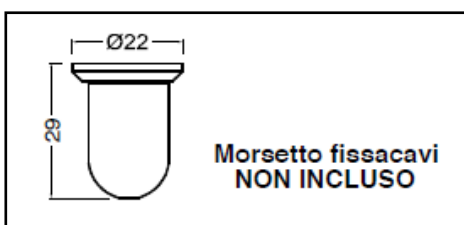

TENDICAVO A SOFFITTO CON ROSETTA

FC16125UR	NICHEL SATINATO
-----------	-----------------

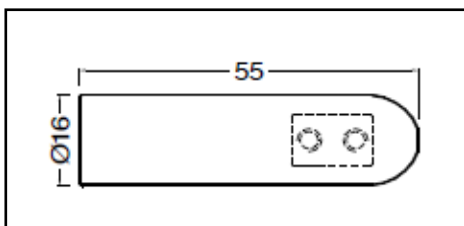

TENDICAVO A PAVIMENTO

FC16125D	NICHEL SATINATO
----------	-----------------

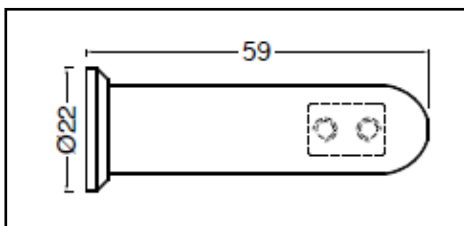

TENDICAVO A PAVIMENTO CON ROSETTA

FC16125DR	NICHEL SATINATO
-----------	-----------------

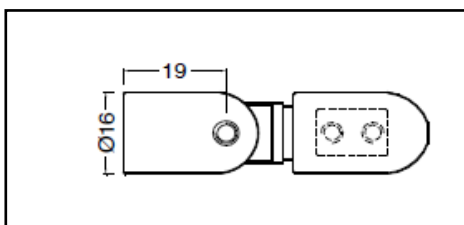

TENDICAVO SNODATO CORTO

SC165T	NICHEL SATINATO
--------	-----------------

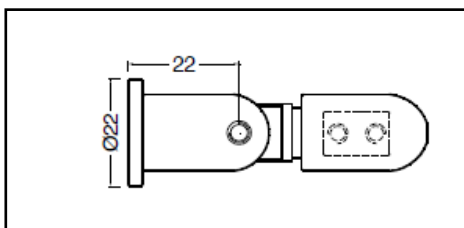

TENDICAVO SNODATO CORTO CON ROSETTA

SC165RT	NICHEL SATINATO
---------	-----------------

REGGIMENSOLE

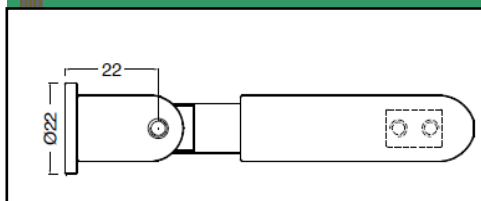

TENDICAVO SNODATO CORTO-LUNGO C/ROSETTA

SCL165RT	NICHEL SATINATO
-----------------	-----------------

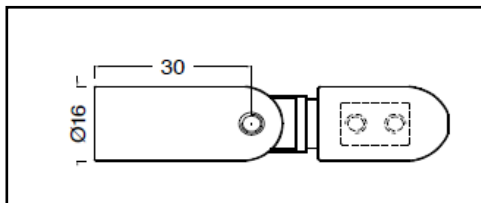

TENDICAVO SNODATO LUNGO-CORTO

SLC165T	NICHEL SATINATO
----------------	-----------------

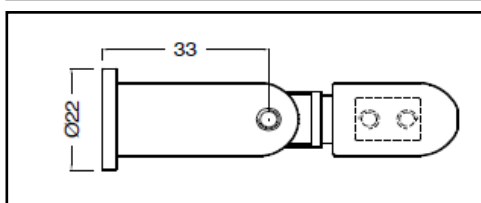

TENDICAVO SNODATO LUNGO-CORTO C/ROSETTA

SLC165RT	NICHEL SATINATO
-----------------	-----------------

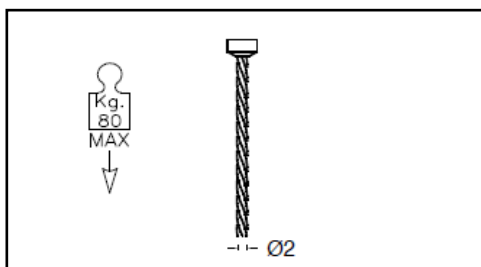

CAVO INOX AISI 316 D.2 19 FILI C/CILINDRO D.6X3.5

CA20015XI	MT 1,50
------------------	---------

CA20020XI	MT 2,00
------------------	---------

CA20025XI	MT 2,50
------------------	---------

CA20030XI	MT 3,00
------------------	---------

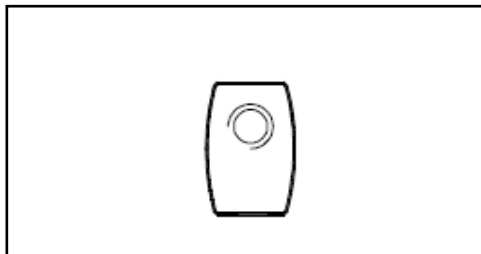

TERMINALI OLIVA PER CAVI

MF08205BK	NICHEL SATINATO
------------------	-----------------

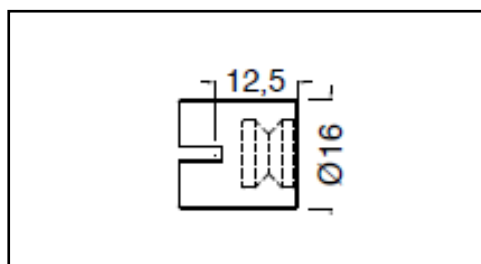

MORSETTO DI TESTA D.16

MR16105KT	NICHEL SATINATO
------------------	-----------------

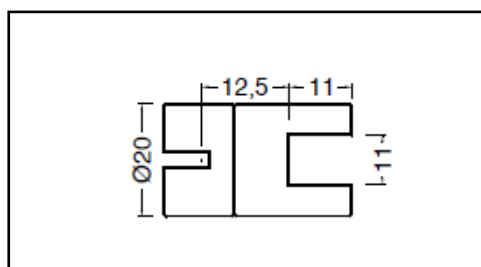

MORSETTO ORIENTABILE PER PANNELLI MM 11

MR20115IT	NICHEL SATINATO
------------------	-----------------

REGGIMENSOLE

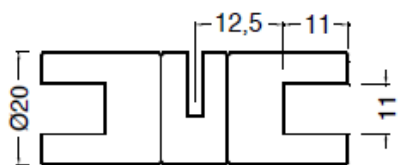

MORSETTO ORIENTABILE PER PANNELLI MM 11

MR20115I2T NICHEL SATINATO

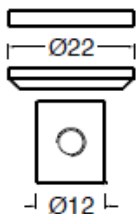

KIT MORSETTO PER CAVO PASSANTE

MR125PKT NICHEL SATINATO



MORSETTO FISSACAVI A SCOMPARSA

MF1002 NICHEL SATINATO

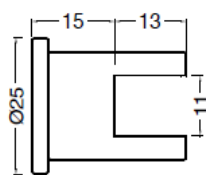

FERMA PANNELLI A BANDIERA D.16
PER SPESSORE MM 11 CON ROSETTA

FP20115BT NICHEL SATINATO

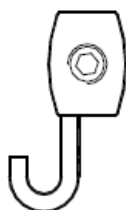

MORSETTO OLIVA CON GANCIO

MF10205BQAT NICHEL SATINATO

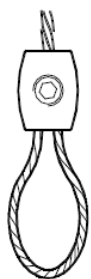

MORSETTO OLIVA PER CAPPIO

MF10205BKT NICHEL SATINATO